

BAXI

Warmth, efficiency,
and total **peace** of mind.

Heating Boilers

High Efficiency, Wall Mounted, Modulating
Condensing Light Commercial Boilers

Baxi has always set the standard for high
efficiency boilers with unsurpassed quality.





Why Choose Baxi?

The Baxi series of light commercial condensing boilers feature stainless steel heat exchangers that achieves efficiencies of 95%. The core of the control system is a microprocessor, the Comfort Master®, which manages and protects the boiler. With this type of burner control you will get the exact output the system requires. Baxi's light commercial series of boilers can be installed in a cascade configuration to match the heating needs of larger buildings. Redundancy and increased building load matching are added benefits when installing multiple boilers. In addition, these boilers produce low emissions with NOx levels below 20 ppm.

Baxi Quality

All Baxi boilers utilize corrosion resistant stainless steel components, such as the heat exchanger and the premix fuel gas burner. Our boilers are designed to provide optimum performance and fuel efficiency. Each boiler is factory test fired with preset burner and controls for quick startup.

150 Plus Years of **BAXI**

1866

Founder Richard Baxendale opened the doors to his new company.



1966

The Bermuda, Baxi's most famous gas-fired boiler was launched. Celebrated 100th anniversary.



1984

A series of acquisitions took place leading to the ownership of the Bassano del Grappa plant in Italy.

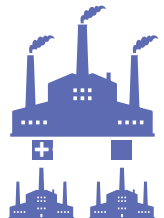

2000

Baxi introduced the first high efficiency combi boiler to North America.



2006

The award-winning Baxi Duo-tec Combi high efficiency boiler was launched.



2010

Baxi merged with De Dietrich and Remeha to form BDR Thermea Group.

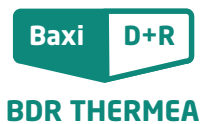

2018

BDR Thermea Group opens Baxi operations in North America.



HEATING Boilers



Standard Equipment:

- High limit sensors
- Low water cut-off
- Shut off valves
- 50 psi ASME Pressure relief valve
- System pressure gauge

Optional Equipment:

- Outdoor Sensor

LIMITED Warranty:

- 2-Year parts warranty
- 10-Year Limited Heat Exchanger

1.70mp Luna Duo-tec

A high efficiency, modulating condensing central heating wall-mounted boiler for large residential and light commercial applications.

Features:

- 240 MBH Input
- 95% AFUE
- 6.7:1 Turndown modulation ratio in central heating mode
- 3 speed, electronically controlled pump
- Stainless steel ANSI 316L pre-mixed burner and heat exchanger
- Anti-wind function - control automatically adjusts the fan speed to prevent loss of flame and lockouts
- Flame stabilization - control allows the flame to stabilize before modulating, preventing flame drop out and recycling
- Electronic Ignition
- Frost Protection Mode
- Vent Materials: coaxial or two-pipe polypropylene
- Gas Types: Natural Gas / Propane
- Dimensions: 17.75"(w) x 23"(d) x 30.06"(h)
- Weight: 120.15 lbs

[Refer to back page for specifications]

A CLOSER LOOK^{1.70MP}

	Luna Duo-tec 1.70MP
1	Condensate trap
2	Gas valve
3	Fan
4	Air/gas collector
5	Primary exchanger
6	Burner sight glass
7	Manual air vent
8	Flue sensor
9	Coaxial flue connector
10	Flue gas test port
11	Combustion air test port
12	Exchanger flange high limit
13	Ignition/Flame detection electrode
14	Spark generator
15	Automatic air vent
16	Auxiliary control board box
17	Air/gas mixer
18	Pump
19	Boiler drain
20	Pressure gauge
21	Low water cutoff
22	Thermal fuse

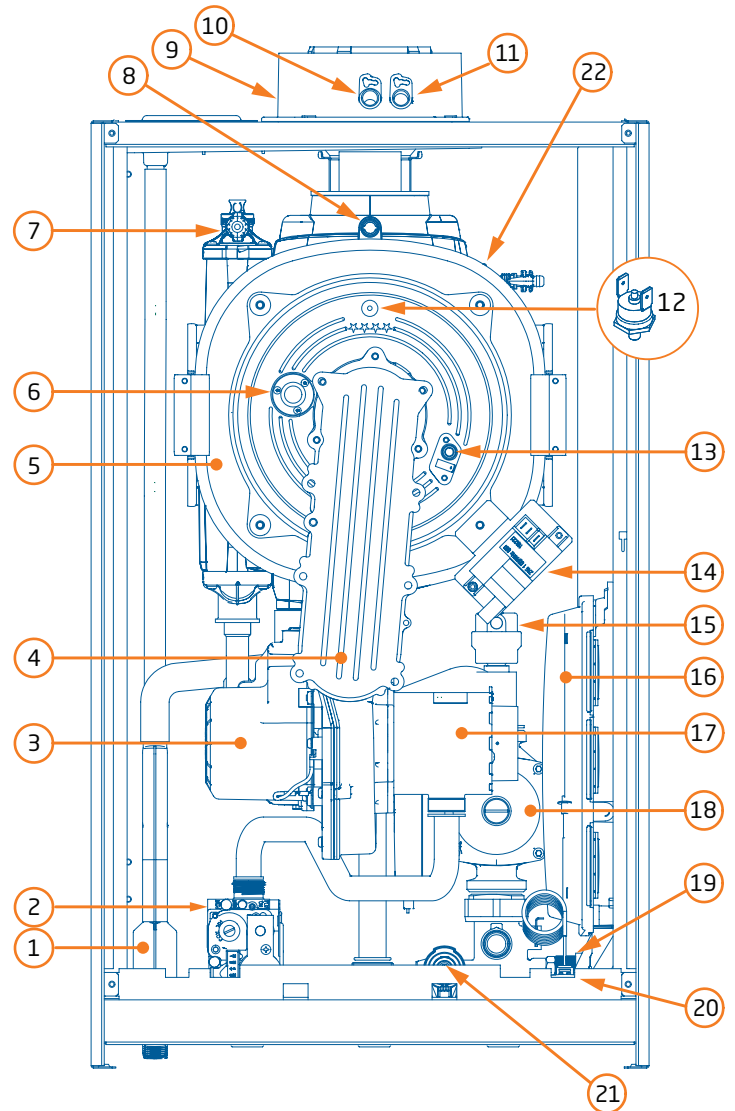

Top of Boiler

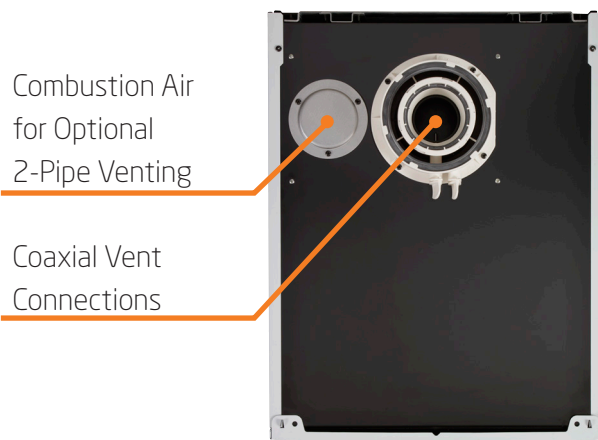

Bottom of Boiler

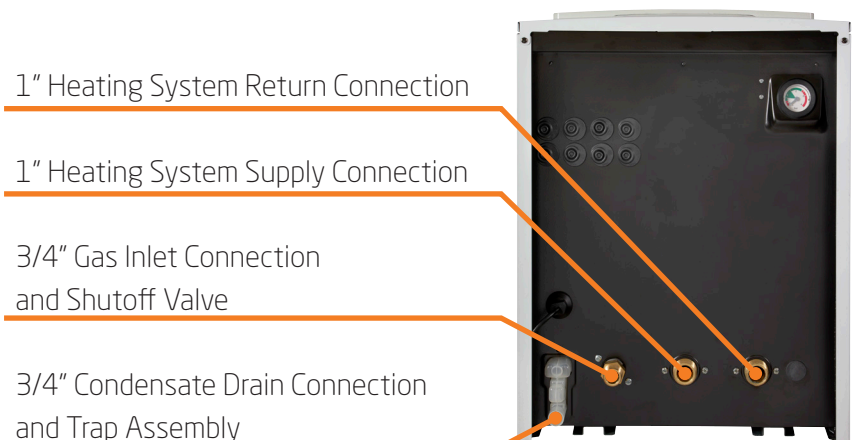

HEATING Boilers



1.110mp Luna Duo-tec

A high efficiency modulating condensing central heating wall-mounted boiler perfect for commercial applications. Compatible with any type of hydronic air handler, wall or baseboard radiator, or in-floor radiant heating system.

Features:

- 380 MBH Input
- 95% Thermal Efficiency
- 10.5:1 Turndown modulation ratio in central heating mode
- Fixed speed pump built in
- Automatic air vent on heat exchanger
- Stainless steel ANSI 316L pre-mixed burner and heat exchanger
- Anti-wind function - control automatically adjusts the fan speed to prevent loss of flame and lockouts
- Flame stabilization - control allows the flame to stabilize before modulating, preventing flame drop out and recycling
- Electronic Ignition
- Frost Protection Mode
- Vent Materials: Coaxial or Two-pipe Polypropylene
- Gas Types: Natural Gas / Propane
- Dimensions: 23.63"(w) x 25.38"(d) x 37.44"(h)
- Weight: 215.6 lbs

Standard Equipment:

- High limit sensors
- Low water cut-off
- Shut off valves
- 50 psi ASME Pressure relief valve
- System pressure gauge

Optional Equipment:

- Outdoor Sensor

LIMITED Warranty:

- 2-Year parts warranty
- 10-Year Limited Heat Exchanger

[Refer to back page for specifications]

A CLOSER LOOK 1.110MP

	Luna Duo-tec 1.110MP
1	Condensate trap
2	Gas valve
3	Fan
4	Air/gas collector
5	Primary exchanger
6	Burner sight glass
7	-
8	Flue sensor
9	Coaxial flue connector
10	Flue gas test port
11	Combustion air test port
12	Exchanger flange high limit
13	Ignition/Flame detection electrode
14	Spark generator
15	Automatic air vent
16	Auxiliary control board box
17	Air/gas mixer
18	Pump
19	Boiler drain
20	Pressure gauge
21	Low water cutoff
22	Thermal fuse

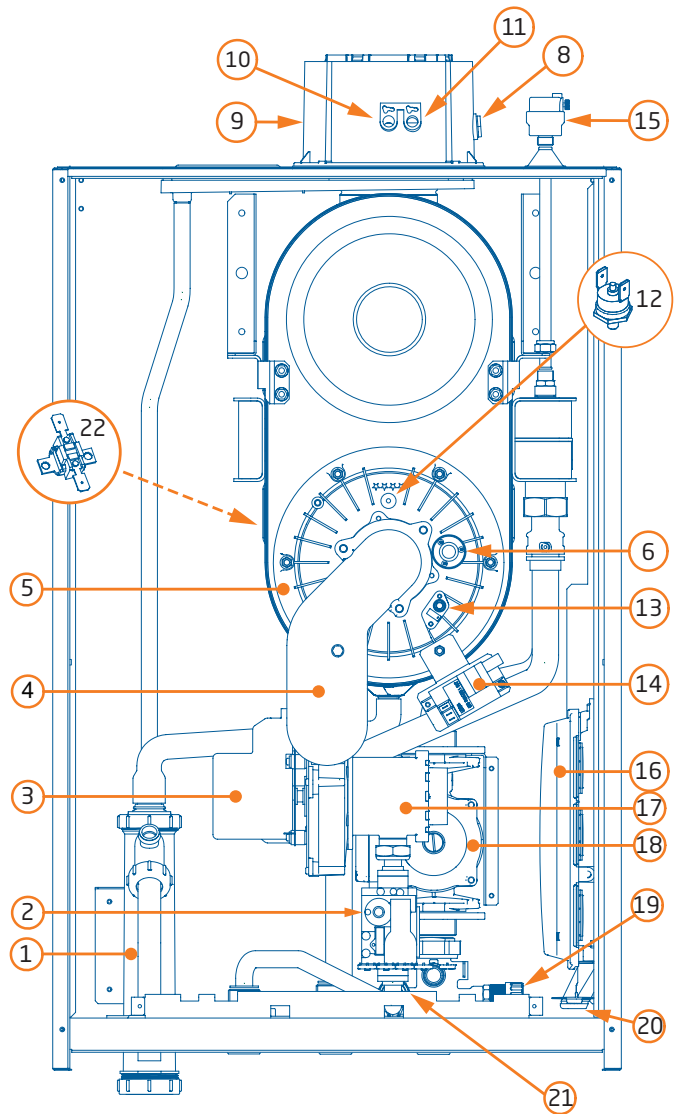

Top of Boiler

Combustion Air
for Optional
2-Pipe Venting

Coaxial Vent
Connections



Bottom of Boiler

1 1/2" Heating System Return Connection

1 1/2" Heating System Supply Connection

1" Gas Inlet Connection
and Shutoff Valve

3/4" Condensate Drain Connection
and Trap Assembly



Product SPECIFICATIONS

SPACE HEATING MODE

	MODEL	INPUT MPH		AHRI CERTIFIED RATINGS		
		MAX	MIN	HEATING CAPACITY MBH	EFFICIENCY AFUE %	NET WATER MBH ⁽¹⁾
HEAT ONLY	1.70 MP	240	36	216	95% AFUE	188
	1.110 MP	380	39	348	95% Thermal	303

(1) Net Water Rating shown based on piping and pickup allowance of 1.15. Consult manufacturer before selecting boilers for installation having unusual piping and pickup requirements, such as intermittent system operation, extensive piping systems, etc.

VENT MATERIAL / SIZE

	MODEL	IN INCHES (mm)		
		COAXIAL ⁽²⁾ Inner Diameter x Outer Diameter	2-PIPE POLYPROPYLENE ⁽²⁾	2-PIPE CPVC ⁽²⁾
HEAT ONLY	1.70 MP	3" x 5" (80mm x 125mm)	3" (80mm)	3" (80mm)
	1.110 MP	4" x 6" (100mm x 160mm)	4" (100mm)	4" (100mm)

(2) Refer to IOM and vent pipe manufacturer's instructions for equivalent lengths and approved venting materials.

CERTIFICATIONS



Baxi is the only company in the heating and sanitary business to have achieved all 3 certifications:
Quality (ISO 9001,) Environment (ISO 14001,) Safety (OHSAS 18001)

BAXI

www.baxiboilers.com



All specifications subject to change without notice.
©2020 Baxi N.A.
PN 240012383 Rev. [01/14/20]